

HOLE LAYOUT ± 0.05

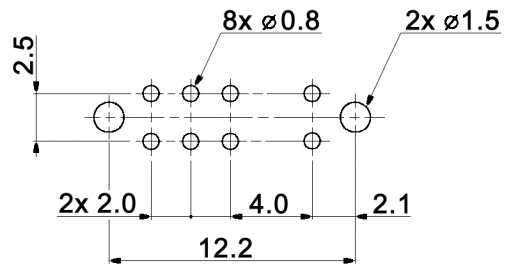

Specifications:

- Contact rating: 0.3A, 30V DC
- Contact resistance: 20mOhm max.
- Insulation resistance: 100MOhm min. at 500V AC for 1 minute
- Dielectric strength: 500V AC (50/60Hz, 2mA) for 1 minute
- Operating temperature: -25°C to +85°C
- Mechanical life: 10 000 cycles
- Operating force: 250 +/-100gf
- Soldering conditions: 260 +/-5°C, 5 +/-1sec.
- Material:
 - Spring plate: phosphor bronze, washing
 - Contact clip: phosphor bronze, silver plated
 - Slider: PA46, black
 - Terminal: brass strip, silver plated
 - Base: phenolic resin, natural
 - Frame: steel, tin plated

CIRCUIT DIAGRAM
C: COMMON PIN
BOTTOM VIEW

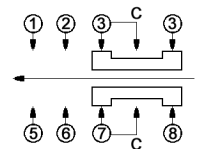

Tolerances: up to 10: ± 0.2 mm above 10-50: ± 0.3 mm	Date	Name
	04/10	dr

MFP 213 P

Specifications	07/13	dr	knitter-switch	30 20 65	Page
Contact rating	03/13	dr			1/1
Modifications	Date	Name			