

**CIRCUIT DIAGRAM**

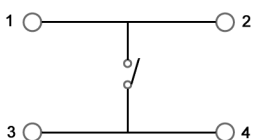

Switching function: off - mom

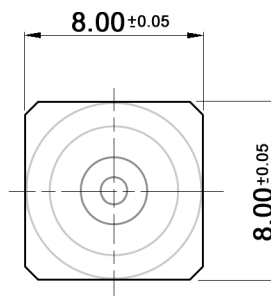

**DRILLING PLAN**

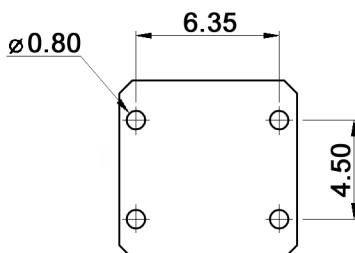

**Specifications:**

Contact rating: 100mA, 42V AC/DC  
 Contact resistance: 100mOhm max.  
 Insulation resistance: 100MOhm min. at 100V DC  
 Dielectric strength: 250V DC, 50Hz for the duration of 1 minute  
 Operating temperature: -40°C to +80°C  
 Mechanical life: 5 000 000 cycles  
 Soldering conditions: wave-soldering: 260°C max., 10sec. max.  
 IP rating: IP67  
 Material: Button: silicone  
 Base: thermoplastic, UL94V-0, blue  
 Contact disc: stainless steel, gold plated over nickel barrier  
 Terminal contact: brass, 0.025µ gold plated  
 Terminal: brass, tin plated

xxx	Operating force (N)	Button color
250	2.5 +/-0.5	natural
350	3.5 +/-0.6	natural
650	6.5 +/-1.3	white

Compliance: RohS III (2015/863/EU)

Tolerances:	Date	Name
		09/20
Button color	01/21	dr
Modifications	Date	Name

**TSE 808-xxx-1**

**knitter-switch**

**30 44 88**

Page

1/1