

P.C.B. MOUNTING

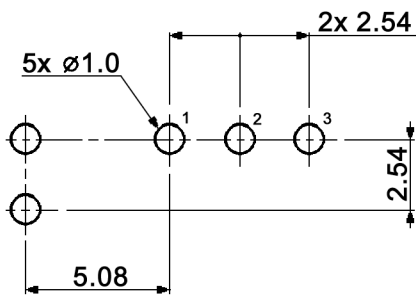

CIRCUIT DIAGRAM

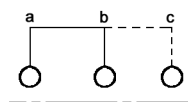

non-shorting

Compliance: RohS II (2011/65/EU)

Tolerances: up to 10: ±0.2mm above 10-50: ±0.3mm	Date	Name
	07/13	dr
ESD resistance	07/14	dr
Modifications	Date	Name

FT 1x-VM

30 29 01

knitter-switch

Page

1/2

Specifications:

Contact rating: max.: 0.15A, 25V DC
 min.: 1µA, 20mV DC
Contact resistance: 100mOhm max.
Insulation resistance: 500MOhm min. at 250V DC for 1 minute
Dielectric strength: 250V AC (50/60Hz, 2mA) for 1 minute
Operating temperature: -40°C to +85°C
Mechanical life: 50 000 cycles
Operating force: 150 +/-100gf
Soldering conditions: 260°C, 10 +/-1sec.; pre-heat: 100°C, 100sec.
ESD resistance: 8kV min. (between actuator and terminals)
Washable by water or alcohol-based cleaners
Material:

- 1 - Actuator: PA66, yellow
- 2 - Spring: stainless steel, temper
- 3 - Housing: PA66, black
- 4 - Plastic washer: silicone rubber, black
- 5 - Plate: brass, 0.7µm tin plated
- 6 - Contact: phosphor bronze, 0.6µm gold plated over 1.3µm nickel
- 7 - Copper pillar: HPB58-3, 3µm nickel plated
- 8 - Base: PA46, black
- 9 - 0.6µm gold plated over 1.3µm nickel

Contact arrangement:

code for x	function	toggle in pos. a	toggle in pos. c
D	On-On	2-3	1-2
F	On-Mom	2-3	1-2

code for x	function	toggle in pos. a	toggle in pos. b	toggle in pos. c
E	On-Off-On	2-3	open	1-2
G	Mom-Off-Mom			
H	On-Off-Mom			

Compliance: RohS II (2011/65/EU)

Tolerances: up to 10: ±0.2mm above 10-50: ±0.3mm		Date	Name	FT 1x-VM
		07/13	dr	
		knitter-switch		30 29 01
				Page 2/2
Modifications	Date	Name		