

P.C.B. MOUNTING HOLE DIMENSIONS

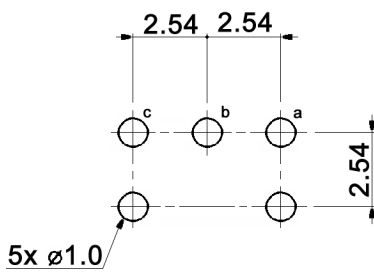

CIRCUIT DIAGRAM

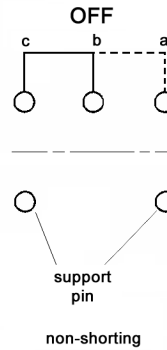

Tolerances: up to 10: ±0.2mm above 10-50: ±0.3mm	Date	Name
	06/11	dr

FT 1 x

knitter-switch

30 23 97

Page

1/2

Modifications	Date	Name
---------------	------	------

Specifications:

Contact rating: max.: 0.15A, 28V DC  
 min.: 1µA, 20mV DC  
 Contact resistance: 100mOhm max.  
 Insulation resistance: 500MOhm min. at 250V DC for 1 minute  
 Dielectric strength: 250V AC (50/60Hz, 2mA) for 1 minute  
 Operating temperature: -40°C to +85°C  
 Mechanical life: 50 000 cycles  
 Operating force: 200 +/-150gf  
 Soldering conditions: pre-heat: max. 100°C, max. 100sec.  
 soldering: max.: 260°C, 10 +/-1sec.

Washable  
 Material:

Base: PA46, black  
 Contact: phosphor bronze, 0.6µm gold plated over 1.3µm nickel  
 Plastic washer: silicone rubber, black  
 Spring: stainless steel, temper  
 Terminal: phosphor bronze, 0.6µm gold plated over 1.3µm nickel  
 Support pin: phosphor bronze, 0.7µm tin plated  
 Case: PA66, black  
 Toggle: PA66, yellow

x	Switch function
D	on - on
E	on - off - on
F	mom - on
G	mom - off - mom
H	mom - off - on



Tolerances: up to 10: ±0.2mm above 10-50: ±0.3mm			Date	Name	<b>FT 1 x</b>
			06/11	dr	
			<b>knitter-switch</b>		<b>30 23 97</b>
Modifications			Date	Name	Page 2/2