

P.C.B. MOUNTING

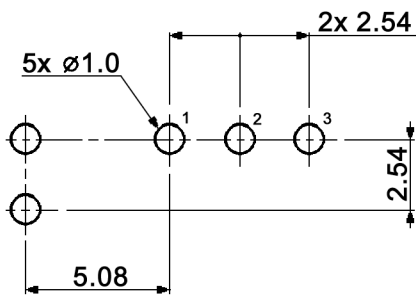

CIRCUIT DIAGRAM

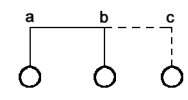

non-shorting

Compliance: RohS II (2011/65/EU)

Tolerances: up to 10: ±0.2mm above 10-50: ±0.3mm		Date	Name	<h1>FT 1x-VM</h1>
		07/13	dr	
			<h2>knitter-switch</h2>	<h1>30 29 01</h1>
ESD resistance	07/14	dr		
Modifications	Date	Name		

**Specifications:**

**Contact rating:** max.: 0.15A, 25V DC  
 min.: 1µA, 20mV DC  
**Contact resistance:** 100mOhm max.  
**Insulation resistance:** 500MOhm min. at 250V DC for 1 minute  
**Dielectric strength:** 250V AC (50/60Hz, 2mA) for 1 minute  
**Operating temperature:** -40°C to +85°C  
**Mechanical life:** 50 000 cycles  
**Operating force:** 150 +/-100gf  
**Soldering conditions:** 260°C, 10 +/-1sec.; pre-heat: 100°C, 100sec.  
**ESD resistance:** 8kV min. (between actuator and terminals)  
**Washable by water or alcohol-based cleaners**  
**Material:**

- 1 - Actuator: PA66, yellow
- 2 - Spring: stainless steel, temper
- 3 - Housing: PA66, black
- 4 - Plastic washer: silicone rubber, black
- 5 - Plate: brass, 0.7µm tin plated
- 6 - Contact: phosphor bronze, 0.6µm gold plated over 1.3µm nickel
- 7 - Copper pillar: HPB58-3, 3µm nickel plated
- 8 - Base: PA46, black
- 9 - 0.6µm gold plated over 1.3µm nickel

**Contact arrangement:**

code for x	function	toggle in pos. a	toggle in pos. c
D	On-On	2-3	1-2
F	On-Mom	2-3	1-2

code for x	function	toggle in pos. a	toggle in pos. b	toggle in pos. c
E	On-Off-On	2-3	open	1-2
G	Mom-Off-Mom			
H	On-Off-Mom			

**Compliance: RohS II (2011/65/EU)**

Tolerances: up to 10: ±0.2mm above 10-50: ±0.3mm		Date	Name	<b>FT 1x-VM</b>
		07/13	dr	
		<b>knitter-switch</b>		<b>30 29 01</b>
				Page 2/2
Modifications	Date	Name		