

P.C.B. LAYOUT

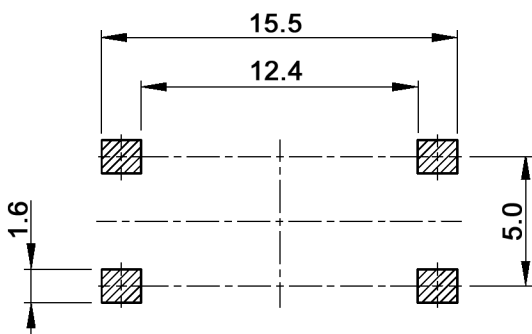

CIRCUIT DIAGRAM

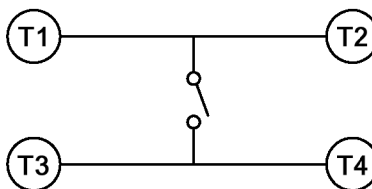

Tolerances: max. $\pm 0.20\text{mm}$	Date	Name
	09/11	dr
Modifications	Date	Name

TSS 21 x

30 24 41

Page

1/2

knitter-switch

Specifications:

Contact rating: 50mA, 12V DC
Contact resistance: 100mOhm max.
Insulation resistance: 100MOhm min. at 500V DC for 1 minute +/-5sec.
Dielectric strength: 250V AC (50/60Hz) for 1 minute
Operating temperature: -25°C to +70°C
Storage temperature: -30°C to +80°C
Travel: 0.35 +/-0.1mm
Material: Cover: stainless steel
 Stem: high-temp. thermoplastic nylon UL94V-0
 Contact: phosphor bronze, silver cladding
 Base: high-temp. thermoplastic nylon UL94V-0
 Terminal: brass, silver plated

Soldering conditions:

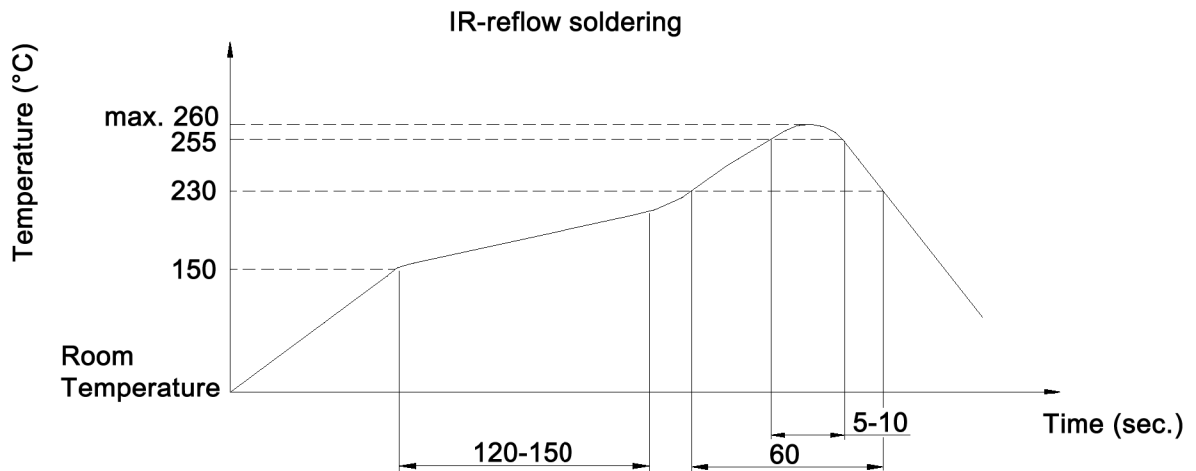

x	Operating force (gf)	Electrical life	Colour of stem
N	160 +/-50	200 000 cycles	brown
R	260 +/-50	100 000 cycles	red
S	320 +/-80	100 000 cycles	salmon
Y	520 +/-130	100 000 cycles	yellow



Tolerances: max. ±0.20mm		Date	Name	TSS 21 x
		09/11	dr	
			knitter-switch	30 24 41
Modifications		Date	Name	Page 2/2