

HOLE LAYOUT  $\oplus 0.05$

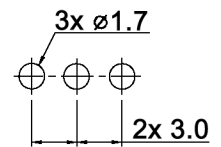

CIRCUIT DIAGRAM  
C: COMMON PIN  
BOTTOM VIEW

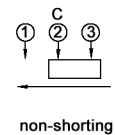

**Specifications:**

- Contact rating: 0.35 A, 30 V DC
- Contact resistance: 20 mOhm max.
- Insulation resistance: 100 MOhm min. at 500 V DC for 1 minute
- Dielectric strength: 500 V AC (50/60 Hz, 2 mA) for 1 minute
- Operating temperature: -40°C to +85°C
- Mechanical life: 10 000 cycles
- Operating force: 150 +/-70 gf
- Soldering conditions: manual soldering: max. 350°C, max. 3 sec.
- Material: Terminal: brass strip, silver plated  
Frame: SPCC, nickel plated  
Base: phenolic resin, natural  
Contact plate: brass strip, silver plated  
Spring: SWC, temper  
Slider: POM, black

Compliance: RohS II (2011/65/EU)

Tolerances: up to 10: ±0.2 mm above 10-50: ±0.3 mm	Date	Name
	03/18	dr
Modifications	Date	Name

**MFS 121 D-N**

**knitter-switch**

**30 40 19**

Page

1/1