

HOLE LAYOUT $\oplus 0.05$

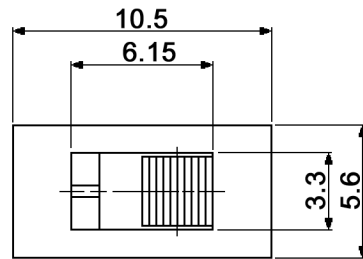
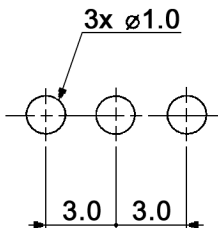

Specifications:

- Contact rating: 0.3A, 50V DC
- Contact resistance: 30mOhm max.
- Insulation resistance: 100MOhm min. at 500V DC for 1 minute
- Dielectric strength: 500V AC (50/60Hz, 2mA) for 1 minute
- Operating temperature: -10°C to +60°C
- Mechanical life: 10 000 cycles
- Operating force: 200 +/-100gf
- Soldering conditions: pre-heat: max. 100°C, max. 100sec.
wave soldering: max. 260°C, max. 6sec.

- Material:**
- Terminal: brass strip, silver plated
 - Frame: SPCC, nickel plated
 - Base: phenolic resin, natural
 - Contact plate: brass strip, silver plated
 - Spring: SWC, temper
 - Slider: PA 66, black

CIRCUIT DIAGRAM
C: COMMON PIN
BOTTOM VIEW

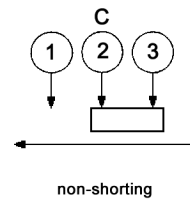

Compliance: RohS II (2011/65/EU)

Tolerances: up to 10: ±0.2mm above 10-50: ±0.3mm	Date	Name
	10/16	dr

MFP 12504

knitter-switch

30 37 00

Page

1/1

Modifications Date Name