

CONTACT ARRANGEMENT

code for x	function	connected terminals
D	ON - ON	1-2, 4-5, 7-8 alternating with 2-3, 5-6, 8-9
F	ON - MOM	rest position: 1-2, 4-5, 7-8; pushed down: 2-3, 5-6, 8-9

RATING AND CONTACT / TERMINAL MATERIAL

y	contacts	all other conductive parts	rating DC	rating AC
empty	Ag (solid)	Brass, 10 µm Ag over 1.5 µm Ni	6V / 6 A 12V / 5 A 30 V / 4 A	125 V / 6 A 250 V / 3 A
B	Brass, 2 µm Au over 3 µm Ni	Brass, 2 µm Au over 3 µm Ni	max. 0.4 VA, max. 20 V AC/DC	
G	Ag (solid), 2 µm Au over 3 µm Ni	Brass, 2 µm Au over 3 µm Ni	6V / 6 A 12V / 5 A 30 V / 4 A 150 V / 10 mA	125 V / 6 A 250 V / 3 A

Specifications:

- Contact resistance: 20mOhm max.
- Insulation resistance: 1 000MOhm min. at 500V DC
- Dielectric strength: 1 500V, 50Hz for the duration of 1 minute
- Operating temperature: -45°C to +140°C
- Mechanical life: 30 000 make-and-break cycles
- Mounting instruction: max. torque 49Ncm
- Material: Terminal: brass, C2010, silver plated
Case: DAP
Housing: stainless steel, CNS 9265
Bushing: copper alloy, C3604BD, nickel plated
Plunger: copper alloy, C3604BD, chrome plated
- Included accessories: 2 pcs. nut M6x0.75, nickel plated, 9mm wrench size
1 pc. tooth washer
1 pc. locking washer

PANEL MOUNTING

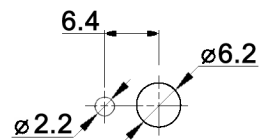

Compliance: RohS II (2011/65/EU)

Tolerances: 0.00: ±0.25mm 0.0: ±0.40mm	Date	Name	MPA 306 x y
	08/13	dr	
knitter-switch			30 29 08
Contact arrangement	07/15	dr	Page 1/1
Modifications	Date	Name	