

PANEL MOUNTING

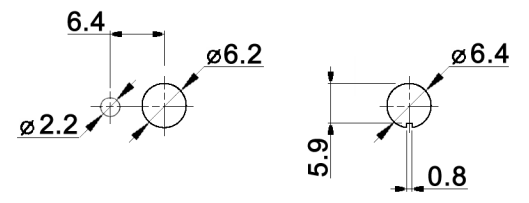

CONTACT ARRANGEMENT

code for x	function	connected terminals
N	ON - ON	1-2, 4-5 alternating with 2-3, 5-6
R	ON - MOM	rest position: 1-2, 4-5; pushed down: 2-3, 5-6

Specifications:

- Contact rating:** 3A, 250V AC / 6A, 125V AC
4A, 30V DC / 5A, 12V DC
6A, 6V DC
- Contact resistance:** 20mOhm max.
- Insulation resistance:** 1 000MOhm min. at 500V DC
- Dielectric strength:** 1 500V, 50Hz for the duration of 1 minute
- Operating temperature:** -45°C to +140°C
- Mechanical life:** 30 000 cycles
- Soldering conditions:** hand-soldering: max.: 420°C, 3sec., 60W
auto-soldering: max.: 270°C, 5sec.
- Mounting instruction:** max. torque: 49Ncm
- Material:** Terminal: brass, C1020 silver plated
Case: DAP
Housing: stainless steel, CNS9265
Bushing: copper alloy, C3604BD nickel plated
Actuator: copper alloy, C3604BD chrome plated
- Included accessories:** 2 pcs. nut M6x0.75, nickel plated, 9mm wrench size
1 pc. tooth washer
1 pc. locking washer

Compliance: RohS II (2011/65/EU)

Tolerances: 0.00: ±0.25mm 0.0: ±0.40mm	Date	Name
	06/09	dr
Contact arrangement	07/15	dr
Dimension	01/11	dr
Panel mounting	05/10	dr
Modifications	Date	Name

MPA 206 x

knitter-switch

30 18 30