

HOLE LAYOUT  $\oplus 0.05$

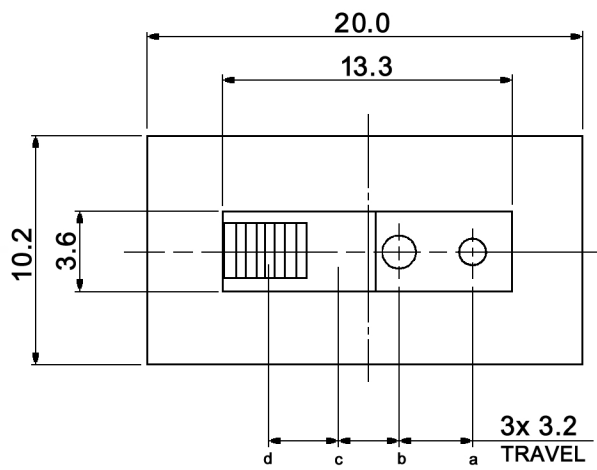
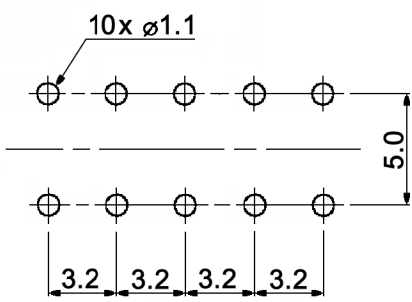

Specifications:

- Contact rating: 0.3A, 30V DC
- Contact resistance: 20mOhm max.
- Insulation resistance: 100MOhm min. at 500V DC for 1 minute
- Dielectric strength: 500V AC (50/60Hz, 2mA) for 1 minute
- Operating temperature: -10°C to +60°C
- Mechanical life: 10 000 cycles
- Operating force: a-b, d-c: 180 +/-80gf  
b-c-d: 250 +/-100gf  
c-b-a: 250 +/-100gf
- Soldering conditions: 260 +/-5°C, 5 +/-1sec.
- Material: Terminal: brass strip, silver plated  
Contact clip: C5210R-EH, silver plated  
Steel ball: carbon steel, natural  
Spring: SWC, temper  
Base: phenolic resin, natural  
Frame: SPCC, tin plated  
Slider: POM, black

CIRCUIT DIAGRAM  
BOTTOM VIEW

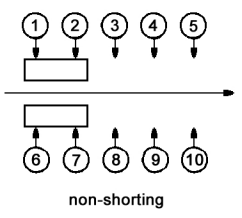

Compliance: RohS II (2011/65/EU)

Tolerances:	up to 10: ±0.2 mm	Date	Name
	above 10-50: ±0.3 mm	12/18	dr

**MFP 240**

**knitter-switch**

**30 41 80**

Page  
1/1

Modifications	Date	Name
---------------	------	------