

(*) 27.5 for 3 contact blocks; 45.8 for 5 contact blocks

(**) 18.2 for 3 contact blocks; 36.4 for 5 contact blocks

Specifications:

Utilization category:	AC-15; A600; 3 A at 240 V; 1.9 A at 380 V DC-13; P600; 0.55 A at 250 V
Rated thermal current:	10 A
Rated insulation voltage:	650 V
Minimum load:	3 V, 5 mA
Contact resistance:	50 mOhm max.
Insulation resistance:	>100 MOhm at 500 V DC
Dielectric strength:	2500 V, 50 Hz for the duration of 1 minute
Operating temperature:	illuminated components: -25°C to +55°C other: -25°C to +70°C
Storage temperature:	-40°C to +85°C
Operation / storage humidity:	45 to 85 % RH
Ingress protection:	IP65 from front
Contamination class:	3
Vibration resistance:	10 - 55 Hz, 0.5 mm
Shock resistance:	10 G (Malfunction), 100 G (Destruction)
Mechanical life:	300k cycles
Electrical life:	100k cycles
Operation force (for ref. only):	30 N
Contact design:	positive break for NC contacts
Number of contact blocks per unit:	5 max.
Referenced safety standards:	UL508, CSA 22.2 No. 4, EN60947-5-1, EN60947-5-2
Compliance:	RohS III (2015/863/EU)

Tolerances: 0-1: ±0.1mm 1-4: ±0.3mm 4-16: ±0.5mm 16-63: ±0.8mm	Date	Name	ICE22RE1x-xx20-Lxxx
	07/18	dr	
			Emergency Switch, Disc Operator
			30 41 07
Panel design	10/23	dr	Page
Modifications	Date	Name	1/2

knitter-switch

30 41 07

Page

1/2

Lxxx	LED	xx	Contacts	x	Disc
L6R	red, 6V AC/DC	10	1 NO	R	red
L12R	red, 12V AC/DC	01	1 NC	R10	red, opaque rim
L24R	red, 24V AC/DC	11	1 NC, 1 NO	G	green
LA1R	red, 110V AC	20	2 NO		
LA2R	red, 220V AC	21	2 NO, 1 NC		
L6B	blue, 6V AC/DC	etc.	etc.		
L12B	blue, 12V AC/DC	until	until		
L24B	blue, 24V AC/DC	41	4 NO, 1 NC		
LA1B	blue, 110V AC	14	1 NO, 4 NC		
LA2B	blue, 220V AC				
L6W	white, 6V AC/DC				
L12W	white, 12V AC/DC				
L24W	white, 24V AC/DC				
LA1W	white, 110V AC				
LA2W	white, 220V AC				
L6Y	yellow, 6V AC/DC				
L12Y	yellow, 12V AC/DC				
L24Y	yellow, 24V AC/DC				
LA1Y	yellow, 110V AC				
LA2Y	yellow, 220V AC				
L6G	green, 6V AC/DC				
L12G	green, 12V AC/DC				
L24G	green, 24V AC/DC				
LA1G	green, 110V AC				
LA2G	green, 220V AC				

NOTE:
 FOR MOMENTARY SWITCHES, THE TOTAL OF NO AND NC IS LIMITED TO 5 MAX.
 FOR LATCHING SWITCHES, THE TOTAL OF NO AND NC IS LIMITED TO 4 MAX.

PANEL CUT-OUT

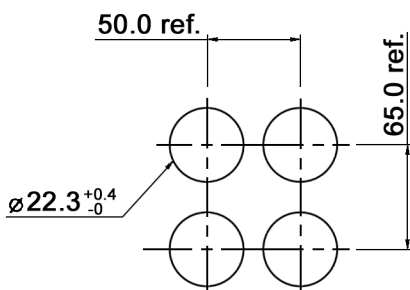

Compliance: RohS III (2015/863/EU)

Tolerances: 0-1: ±0.1mm 1-4: ±0.3mm 4-16: ±0.5mm 16-63: ±0.8mm	Date	Name	ICE22RE1x-xx20-Lxxx
	07/18	dr	
			Emergency Switch, Disc Operator
			30 41 07
Panel design	10/23	dr	Page
Modifications	Date	Name	2/2

knitter-switch